

# FOR ELECTRIC MOTOR DRIVE

with Mechanical Seal – for “C” Face Motors  
2-1/2" x 2" Pipe Size

# SERIES 200 STRAIGHT CENTRIFUGAL 2-1/2" x 2"

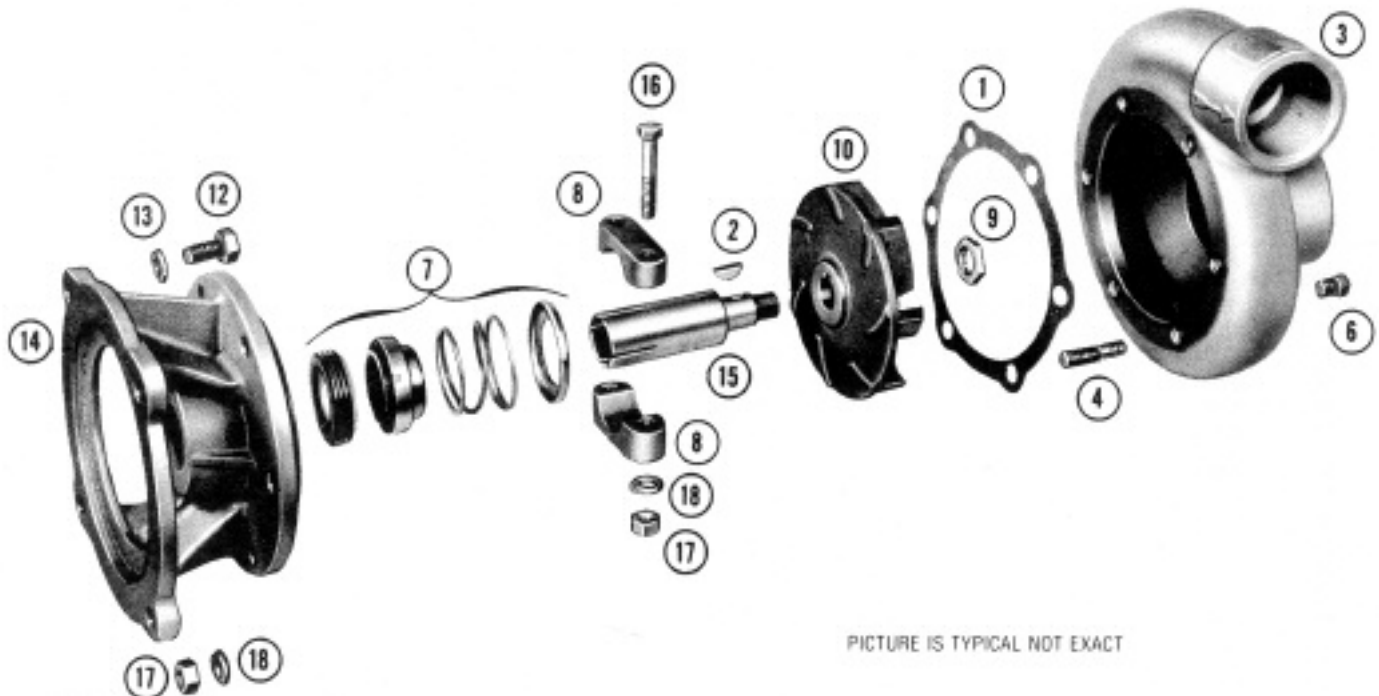

PICTURE IS TYPICAL NOT EXACT

**IMPORTANT:** When ordering parts, specify MODEL and SERIAL number shown on nameplate.  
**NOTE:** Parts shown are typical, not necessarily actual views.

ITEM NO.	PART NO.	DESCRIPTION	QUANTITY REQUIRED PER MODEL			
			ROTATION	ALL MODELS LISTED ARE RIGHT HAND		
			PIPE SIZE	2-1/2" x 2"	2-1/2" x 2"	2-1/2" x 2"
			METAL	CAST IRON	ALUMINUM	BRONZE
MODEL NOS.	23234	NA	23233			
	23237	NA	23236			
	25032		NA			
	25027		NA			

### HOUSING

3	24218	Housing Assembly — Inc:	1		
		Housing — Cast Iron	1		
4	21261	Stud — S.S. — 3/8"	6		
6	21267	Pipe Plug — S.S. — 1/4" NPT	2		
3	24163	Housing Assembly — Inc:		1	
		Housing — Aluminum		1	
4	21261	Stud — S.S. — 3/8"		6	
6	21267	Pipe Plug — S.S. — 1/4" NPT		1	
3	24164	Housing Assembly — Inc:			1
		Housing — Bronze			1
4	21721	Stud — Bronze 3/8"			6
6	21186	Pipe Plug — Bronze 1/4" NPT			1
17	21268	Hex Nut — S.S. — 3/8"	6	6	
17	21230	Hex Nut — Bronze — 3/8"			6
18	21266	Lockwasher — S.S. — 3/8"	6	6	
18	25051	Lockwasher — Bronze — 3/8"			6
1	21216	Gasket — Housing	1	1	1



34800 BENNETT • FRASER, MI 48026-1686  
(586) 293-8240 • FAX (586) 293-8469  
(800) 563-8006 • www.mppumps.com

**SERVICE PARTS LIST**  
**FORM 7019-A**

ITEM NO.	PART NO.	DESCRIPTION	QUANTITY REQUIRED PER MODEL			
			ROTATION ALL MODELS LISTED ARE RIGHT HAND			
			PIPE SIZE	2-1/2" x 2"	2-1/2" x 2"	2-1/2" x 2"
			METAL	CAST IRON	ALUMINUM	BRONZE
MODEL NOS.	23234 23237 25032 25027	NA NA	23233 23236 NA NA			

**IMPELLER**

10	22686	Impeller — 4-1/8" — Cast Iron — (Model 23237)	1		
10	NA	Impeller — 4-1/8" Dia. — Aluminum — (Model 23235)		1	
10	22685	Impeller — 4-1/8" Dia. — Bronze — (Model 23236)			1
10	22689	Impeller — 4-5/8" Dia. — Cast Iron — (Model 23234)	1		
10	NA	Impeller — 4-5/8" Dia. — Aluminum — (Model 24208)		1	
10	22688	Impeller — 4-5/8" Dia. — Bronze — (Model 23233)			1
10	25031	Impeller — 5.4" 15° — Cast Iron — (Model 25032)	1		
10	25113	Impeller — 5.0" 15° — Cast Iron — (Model 25242)	1		
10	25026	Impeller — 5.4" 22° — Cast Iron — (Model 25027)	1		
10	25976	Impeller — 5.0" 22° — Cast Iron — (Model 25977)	1		
10	26032	Impeller — 4.75" 22° — Cast Iron — (Model 26033)	1		
10	25269	Impeller — 5.4" 15° — Bronze — (Model 25651)			1
10	25543	Impeller — 5.4" 22° — Bronze — (Model 25649 & 25612)			1
9	22655	Impeller Lock Nut — S.S. — 5/8"	1	1	1
15	22679	Impeller Drive Sleeve — 1-1/8"	1	1	1
2	21762	Woodruff Key — 15° — S.S. #8	1	1	1

**CLAMP**

8	23039	Clamp Assembly — Inc:	1	1	1
		Clamp	2	2	2
17	21268	Hex Nut — S.S. — 3/8"	2	2	2
18	21266	Lockwasher — S.S. — 3/8"	2	2	2
16	21269	Capscrew — S.S. — 3/8"	2	2	2

**SEAL**

7	22361	Seal Assembly — Inc:	1	1	1
		Seal Washer	1	1	1
		Seal Seat	1	1	1

**ADAPTOR**

14	22682	Adaptor — Cast Iron	1		
14	NA	Adaptor — Aluminum		1	
14	22681	Adaptor — Bronze			1
12	21246	Capscrew — S.S. — 1/2"	4	4	4
13	21254	Lockwasher — S.S.	4	4	4